

| ITEM NO. | PART NUMBER | DESCRIPTION | QTY. |
|----------|-------------|-----------------------|------|
| 1 | D001476 | Main weldment | 1 |
| 2 | T2000 | Blade Assembly | 3 |
| 3 | T2016 | Spade Skid Plate | 1 |
| 4 | H2091 | 3 Lever Valve | 1 |
| 5 | T1001 | 70" Cylinder | 3 |
| 6 | T2003 | Control Arm | 1 |
| 7 | T2011 | Valve Plate 3 Lever | 1 |
| 8 | T2002 | Bottom Valve Arm | 1 |
| 9 | P2024 | 1x5.625 Snap Ring Pin | 3 |
| 10 | P2023 | 1x2.25 Snap Ring Pin | 3 |

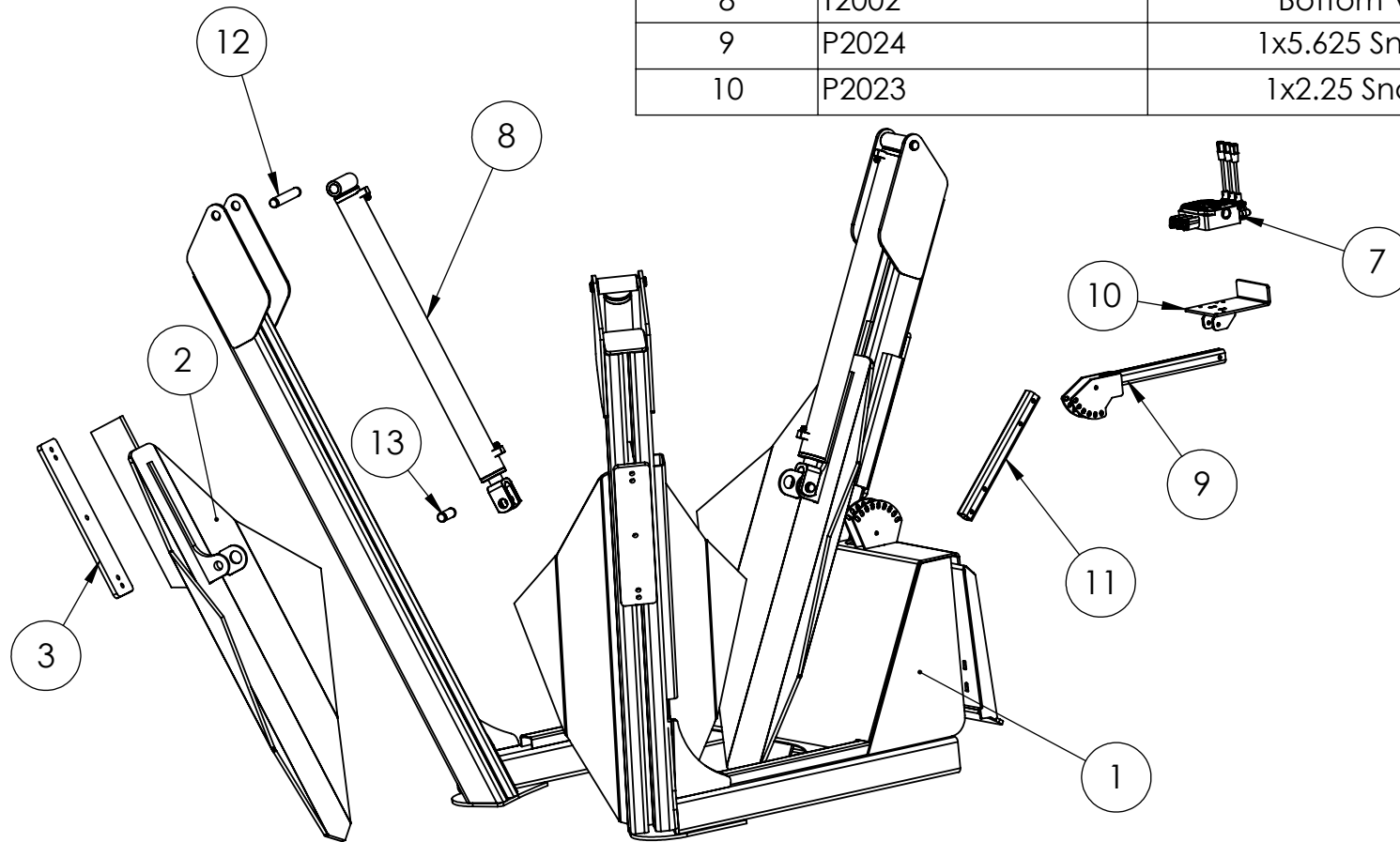

PROPRIETARY AND CONFIDENTIAL
 THE INFORMATION CONTAINED IN THIS
 DRAWING IS THE SOLE PROPERTY OF
BAUMALIGHT. ANY REPRODUCTION IN
 PART OR AS A WHOLE WITHOUT THE
 WRITTEN PERMISSION OF **BAUMALIGHT**
 IS PROHIBITED.



Description

Weight
796.24lbs.

DATE
11/19/2010

DWG. NO.
ST330

REV
A

DO NOT SCALE DRAWING

SCALE: 1:50

SHEET 1 OF 1

5

4

3

2

1